

Michael's®

Made by you™

# Colorful Crystal Bracelets



*John Bead*  
ESTABLISHED 1954

## What You'll Need

Size 11/0 Czech Seed Bead, Transparent Dark Aqua, SKU 10627231

Size 6/0 Czech Seed Bead, Aqua Mix, SKU 10627184

8mm Czech Crystal, Crystal, SKU 10719417

22-gauge German Style Wire, SKU 10121778

Wildfire .006 Frost, SKU 10104818

Size 11 Beading Needle, SKU 10720246

Stainless Lobster Claw Clasp, SKU 10697686

6mm Stainless Jump Rings, SKU 10697688

Bail Forming Pliers, SKU 10223254

Flush Cutters, SKU 10443472

Chain Nose Pliers, SKU 10443474

## Beginner Wire Work and Bead Weaving 1-Hour

John Bead has a Facebook Group!

Share your creations with us!

Tag #MakeItWithMichaels and #JohnBead



## Introduction

Sometimes it can be handy to create our own guiding components for our seed beading work. This project is a fun way to play with integrating a large crystal into a bead weaving design that is both stunning and strong. This document will show all steps to create crystal components and integrate them into a right angle weave design. On the last page, there is one more idea you can try.

Abbreviations used in the instructions:

S11 - Size 11/0 Czech Seed Bead

S6 - Size 6/0 Czech Seed Bead

R8 - 8mm Round Czech Crystal

## Step 1

First step is to create a set of components. These are super easy to make, and with consistency, using bail forming pliers. Make 6. You can work these in factory style by performing each of the steps in serial.

Cut 1.75" of 22-gauge German style wire

Using the smallest step on the bail forming pliers, roll a double coil to meet the base of the wire, then bend slightly to center the coil.

String on (1)R8. Bend the wire forward. This step is crucial for a centered coil.

Use bail forming pliers at the smallest step to roll forward a double coil.

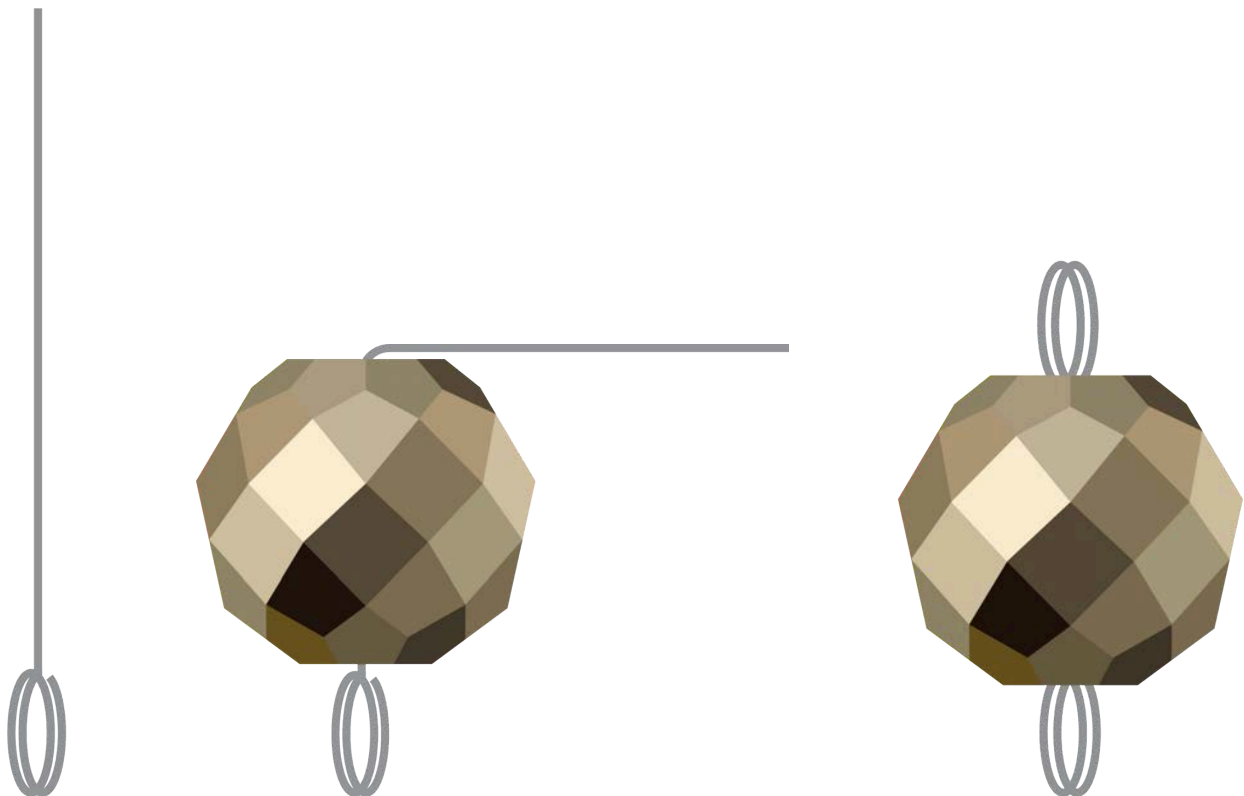

## Step 2

Cut a length of beading thread, 60 to 70-inches. Leaving a 7-inch tail, string (1)S6 and (1)S11 four times. Go back through the first S6, then loop around to reinforce.

## Step 3

String (1)S11 and (1)S6, plus (1)S11. Continue through the S6 you're exiting. Loop around to reinforce. Exit from the top S6.

## Step 4

Repeat Step 3, but replace the second S6 with your first crystal component, going through the coil. Reinforce that connection around. Exit from the coil. String (1)S11 and (1)S6 four times, plus (1)S11. Go through the top coil. String (1)S11 and (1)S6 four times, plus (1)S11 and go through the bottom coil. Loop around to reinforce and exit from the top coil.

## Step 5

Create two Step 3 segments, where the bottom S6 is your coil, and the top S6 of the top segment is the bottom coil of the next crystal. Then repeat the same count of seed beads around the crystal as shown in Step 4. Repeat to add all six crystals components.

## Step 6

End with three, Step 3 segments.

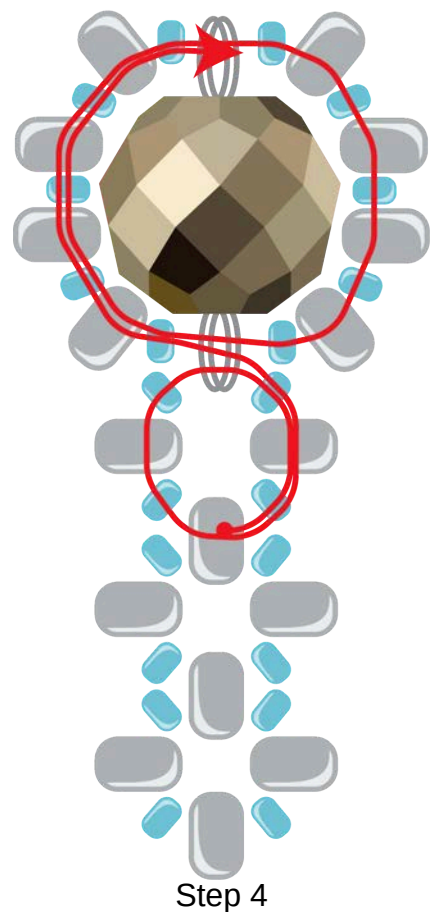
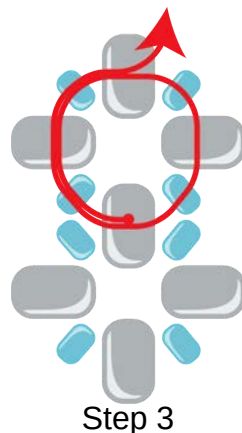
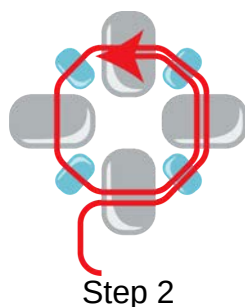

Alternative idea:

It is possible to create the bracelet using a strand of fine beading wire. Start with a long strand of 25 to 30-inches. The resulting bracelet will be more wavy in appearance. String a lobster claw clasp or chain segment and bring it to the midpoint. Slide a crimp bead onto both ends and bring it to sit with air above the clasp. Perform a crimp.

Bring the beading wire through an S6 in opposite directions. Next, string the segment repeat of (1)S11, (1)S6, (1)S11 onto each side. Bring each side through another S6 in the opposite direction.

Repeat this method to create all segments. Finish by bringing both strands through a crimp bead. Bring one of the strands back through the crimp after going through the jump ring.

